

Grounding Cluster Block

Features

For installation on a pole or structure. The 11.5" bar accepts up to four grounding clamps. Bar is 3/4" tinned copper.

Rating 43 kA ASTM.

Material

Aluminum casting
3/4" dia. tinned copper bar

Catalog #	Mounting	Weight
HC-10111	Chain tightener	6.7 lbs

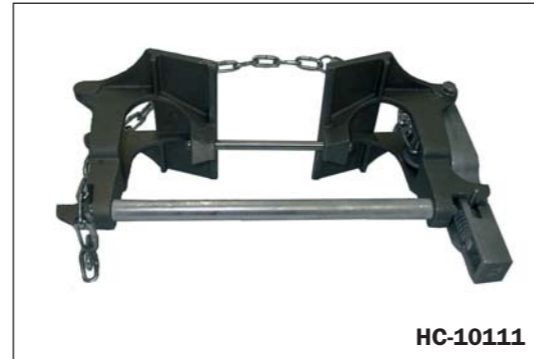

Three-way Grounding Block

Features

Connection joint in a temporary grounding three phase assembly.

HC-10066-R tested up to 27kA (ASTM) and 22kA (IEC).

HC-10093 tested up to 49kA (ASTM) and 35kA (IEC).

Material:

Aluminum 6061-T6
HC-10066-R has black Polyurethane coating.

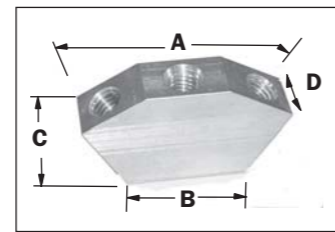

Holes: 5/8-11UNC **HC-10093**

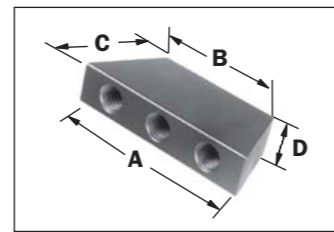

Holes: 5/8-11UNC **HC-10066-R**

Catalog #	Jumper Cable		Dimensions (in.)				Capacity 15 Cycles		Weight (lbs.)
	min.	max.	A	B	C	D	ASTM	IEC	
HC-10066-R	2 AWG	2/0 AWG	4-7/8	3-1/4	2-5/16	1-1/4	27 kA	22 kA	0.3
HC-10093	2 AWG	4/0 AWG	3-3/4	2-3/8	2	1	49 kA	35 kA	0.3

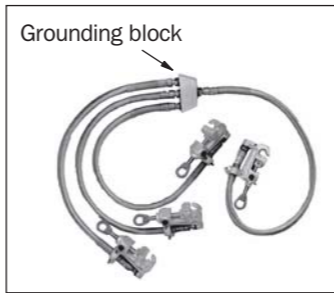

Flags with Magnetized Base

For installation on any steel surface.

Corrosion-resistant magnet.

Installation eye for use with shotgun stick.

Material: Base: Steel with Polyurethane coating.
Rod: Fiberglass.



Warning Tape Reel

Holds 2" wide warning tape.

Unique mechanism prevents fraying of tape.

Locking handle.

Sturdy plastic hook used to attach tape end to a pole or any other structure.

Material

Enclosure: Polyurethane. Tape: Vinyl.
Handle: Aluminum. Hardware: Stainless Steel.



TEMPORARY GROUNDING FOR HIGH ASYMMETRY CURRENT APPLICATIONS



Universal Grounding Clamp

Features

Can be installed on all electrical facilities, apparatus, tubes and conductors as well as various equipment (trucks, pulling equipment, etc.).

This universal clamp can also be used on a jumper cable.

Installation on conductor, round bus bar and grounding ball stud of 20mm and 25mm

Stress-relief to reduce cable damage and serve as a shock damper if fault occurs.

Location on each side of the clamp for 20mm or 25mm parking or grounding ball studs.

Fitted to receive a 5/8-11UNC threaded stud ferrule.

Lubrication chamber for upkeep of threads.

Installation eye for use with shotgun stick.

Double internal threads for fast installation and removal.

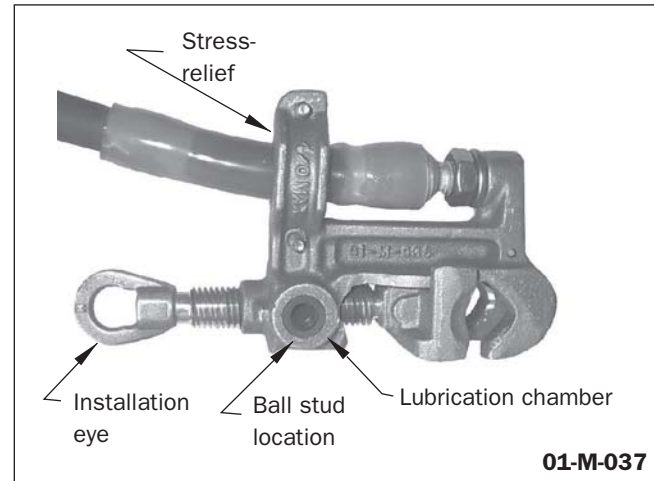

Material

Aluminum body, keeper and eyescrew

Catalog No.	For Grounding Ball Stud	Jumper Cable		Main Conductor (in.)		Jaw Opening (in.)	Capacity 15 Cycles	Capacity 30 Cycles	Peak Current Rating	Weight (lbs.)
		Min.	Max.	Min.	Max.					
01-M-034	20mm	2 AWG	4/0 AWG	(0.13) 8 AWG	(0.86) 556 MCM	1-3/8	35 kA (IEC) 43 kA (ASTM)	30 kA (ASTM)	107 kA	1.3
01-M-037	25mm	2 AWG	4/0 AWG	(0.13) 8 AWG	(1.13) 795 MCM	1-3/8	35 kA (IEC) 55 kA (ASTM)	39kA (ASTM)	116 kA	1.4

Notes:

1- HC-30033 ball stud can be used as a grounding stud with 01-M-037

2 - If a "T" handle screw is required instead of eyescrew, add suffix "-T" to catalog no.

Duck Bill Grounding Clamp

Features

Installation on 0.162" to 1.162" diameter cables.

Lubrication chamber for upkeep of threads.

3/4-10 UNC double lead threads for strength, fast installation and removal.

Stress-relief to reduce cable damage and serve as a shock damper if fault occurs.

Material

Aluminum

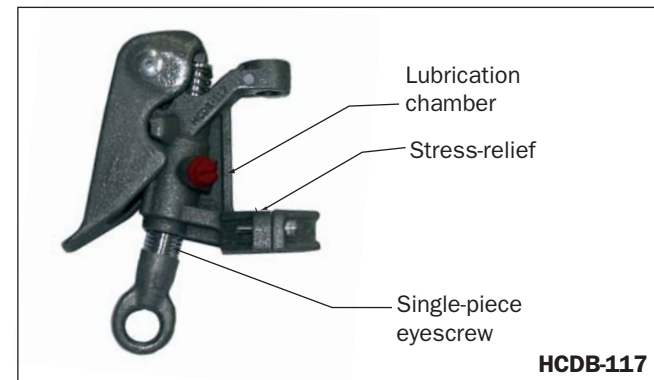

Catalog No.	Jumper Cable		Dimensions (in.)	Main Conductor (in.)		Capacity 15 cycles	Capacity 30 cycles	Peak Current rating	Weight (lbs.)
	Min.	Max.		Min.	Max.				
HCDB-117	2 AWG	4/0 AWG	6-7/8 x 5-1/2 x 2-7/8	(0.16) 6 AWG	(1.162) 900 MCM	35 kA IEC** 50 kA(ASTM)**	35 kA (ASTM)**	113 kA	1.2
HCDB-117S*	2 AWG	4/0 AWG	6-7/8 x 5-1/2 x 2-7/8	(0.16) 6 AWG	(1.162) 900 MCM	35 kA IEC** 50 kA(ASTM)**	35 kA (ASTM)**	113 kA	1.2

*: HCDB-117S has a serrated jaw.

**: IEC rating is phase-phase on 900 MCM conductor, ASTM rating is phase-ground on 900 MCM conductor

Universal Transmission Grounding Clamp & Accessories

Features

Can be installed on all electrical facilities, apparatus, tubes and conductors as well as various equipment (trucks, pulling equipment, etc.).

Installation on 30mm grounding ball stud, conductor or bus bar.

Stress-relief to reduce cable damage.

Fitted to receive a 5/8-11 UNC threaded stud ferrule.

Lubrication chamber for upkeep of threads.

Installation eye for use with shotgun stick.

Double internal threads for fast installation and removal

No exposed threads for minimized maintenance.

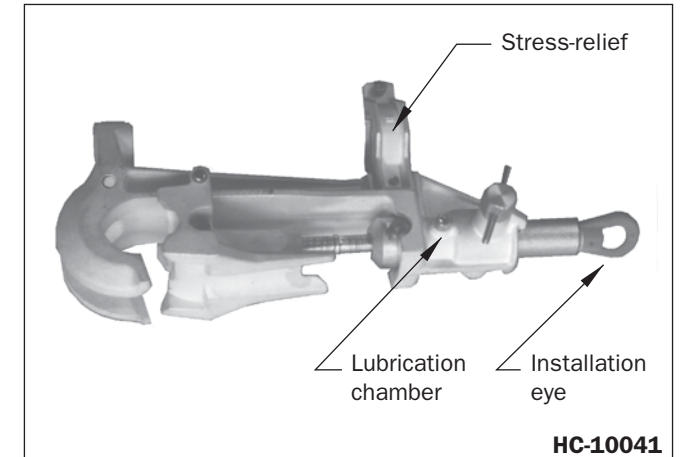

Material

Aluminum body and eyescrew.

Catalog No.	Dimensions (in.)	Jumper Cable		Main Conductor (in.)		Jaw Opening (in.)	Capacity 15 Cycles	Capacity 30 Cycles	Peak Current Rating	Weight (lbs.)
		Min.	Max.	Min.	Max.					
HC-10041	15-1/2 x 6-1/2 x 3-1/4	2 AWG	500 MCM	0.40 1/0 AWG	1.34 1796 MCM	2	55 kA (IEC) 74 kA (ASTM)	61 kA (ASTM)	187 kA	3.9

Note: This clamp meets ASTM class 7 requirement for temporary grounding.

Grounding Ball Studs

Features

Permanent grounding studs permit universal and ball stud clamps to be used for different electrical systems such as apparatus, bus bars, conductors, vehicles, reel, etc.

Spherical form of grounding ball stud permits installation of grounding clamp at various angles to reach the most inaccessible areas.

Stainless steel hardware (washer, lock washer and nut) included (if applicable).

Material

99.9% electrolytic tinned copper.

Catalog #		Capacity 15 Cycles	Peak Current Rating
HC-30029 series	25 mm Ball stud	35 kA (IEC) 55 kA (ASTM)	116 kA
HC-30012 series	30 mm Ball stud	61 kA (IEC) 80 kA (ASTM)	175 kA
03-M-015	3/4 " Stud	61 kA (IEC) 80 kA (ASTM)	175 kA

