

STANDARD TOLERANCES (UNLESS OTHERWISE NOTED)				
	DECIMAL (IN)	FRACTIONS (IN)	ANGLES (DEG)	
MACHINE	.XX ±.01	.XXX ±.005	+ - 1/64	+ - 1/2
FABRICATION			+ - 1/16	+ - 1
CASTING/FORGING	+ - 0.031	+ - 1/32	+ - 1/2	

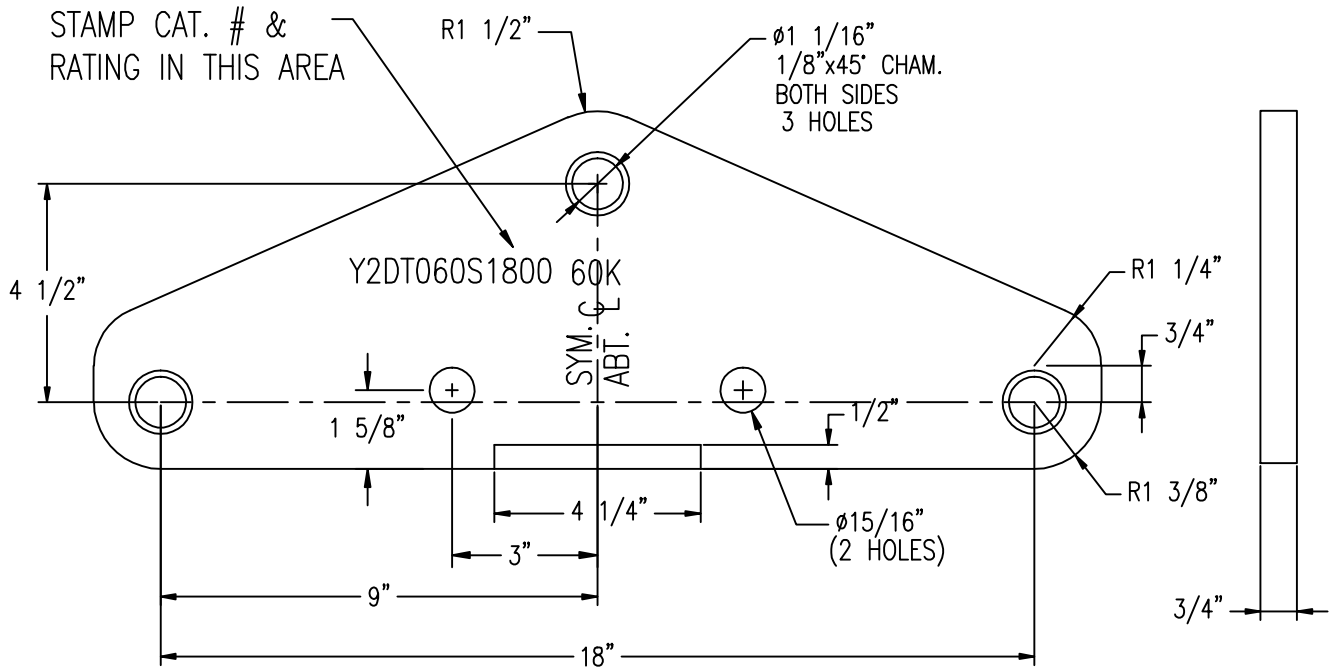

NOTES:

1. MATERIAL - STEEL, ASTM A572 GR. 50
HOT DIP GALVANIZED PER ASTM A153
2. ULTIMATE STRENGTH - 60,000 LBS.
3. MARKING - Y2DT060S1800, 60K (3/8' LETTERS).
4. REMOVE ALL BURRS AND RAGGED EDGES
5. ALL HOLES TO BE DRILLED
6. TO BE FLAME CUT, NO SHEARING
7. EST. WEIGHT 22 LBS

NO.	DATE	DESCRIPTION	BY	CKD
1	8/11/10	Added marking 60K.	WCL	

REVISIONS

BETHEA POWER PRODUCTS
 PELHAM, ALABAMA

A MacLean Power Systems Co.

TRIANGULAR DE STEEL YOKE
 CAT. NO. Y2DT060S1800

DATE: 4/27/10	SCALE: NONE	NO. AM-7360-65	R/1	SH.1 OF 1
BY: WCL	BY:	BY:		