

REVISIONS			
NO.	DATE	DESCRIPTION	BY
1	4/22/22	PART CONSOLIDATION. RANGE WAS 25--57", SUB PARTS CHANGED	KMK WGL

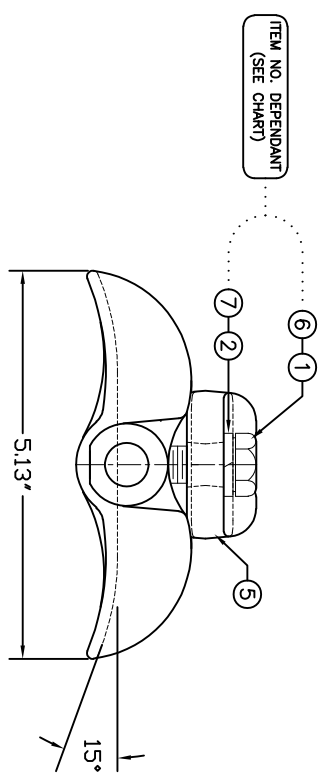
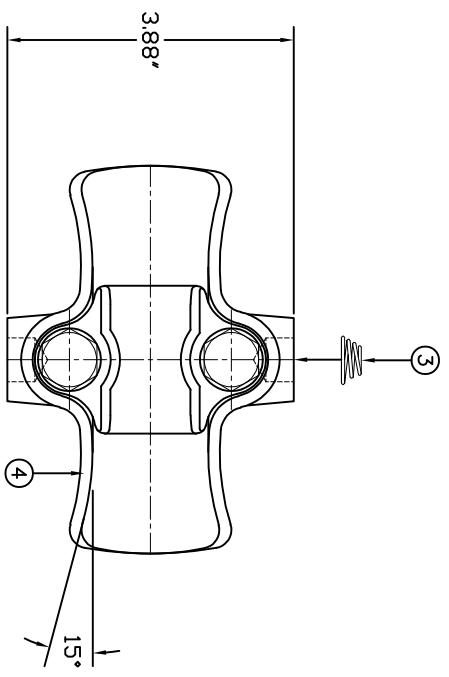

ITEM NO. DEPENDANT  
(SEE CHART)

ITEM NO.	PART NO.	CAT. NO.	DESCRIPTION	QUANTITY			
				A	B	C	D
1	P55930	H-0156-02	1/2"x1-3/4" BRONZE HHB	2	2		
2	P56409	H-0521-04	1/2" BRONZE LOCKWASHER	2	2		
3	P60279	H-0480-02	CONICAL COMPRESSION SPRING	1	1		
4	P59557	LPS-5786BR-B	LPS57/86 BRONZE BODY MACH	1	1		
5	P59556B	LPS-5786BR-KU	LPS5786 BRONZE KEEPER	1	1		

ASSEMBLY NUMBER	REF. NO.	KEEPER ASSEMBLY
LPS-57B	A	MAX GROOVE UP
	B	
	C	
	D	

NOTE: LPS-86B MIN GROOVE UP

- NOTES:
- MATERIAL - BODY AND KEEPER: HIGH STRENGTH BRONZE  
HARDWARE: BRONZE  
SPRING: STAINLESS STEEL
  - ULTIMATE STRENGTH: 5,000 LBS.
  - CLAMPING RANGE - 0.23" TO 0.86"

**MACLEAN POWER SYSTEMS**  
A Maclean-fogg Company

TOP LINE POST INSULATOR ANGLE CLAMP  
LPS-57B

ENG. REF.	DATE 12/27/2011	SCALE NONE	NO.	BC8587-1	R / 1
	DRN. CAR	DRG.	REV.		SH. 1

This information is confidential and is the property of Maclean Power Systems. It may not be made public or reproduced except that the Customer may make copies for use solely in installation, maintenance, and operation of products supplied by Maclean Power Systems.