

REVISIONS				
NO.	DATE	DESCRIPTION	BY	CKD

ITEM NO.	PART NO.	CAT. NO.	DESCRIPTION	QUANTITY			
				A	B	C	D
1	P55848	H-0123-04	1/2"x3" GR5 CARRIAGE BOLT	1			
2	P56092	H-0315-01	5/8"φ x 1-3/4" CLEVIS PIN	1			
3	P56109	H-0360-01	COTTER PIN HMP 5/8"	1			
4	P56137	H-0400-04	1/2"-13 HEX NUT FIN	1			
5	P56294	H-0500-04	1/2" FLATWASHER	1			
6	P59077	P-0470-01	ALS-1 BODY CST	1			
7	P59078	*RALS-1K	ALS-1 & RALS-1 KEEPER	1			

ASSEMBLY NUMBER	REF. NO.
ALS-1-N	A
	B
	C
	D

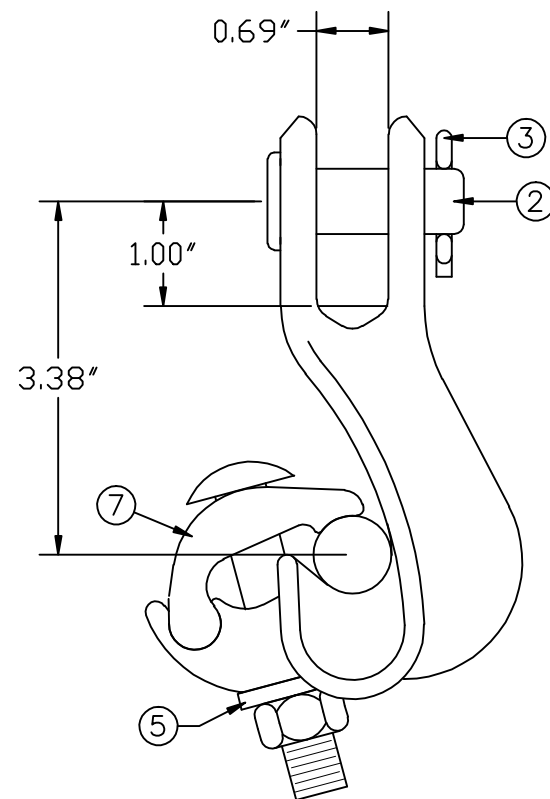
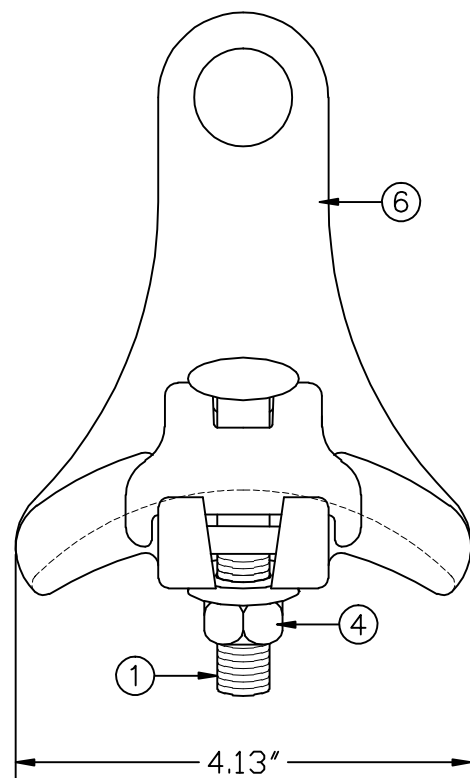

NOTES:

- MATERIAL - BODY & KEEPER:
ALUMINUM ALLOY A356-T6

HARDWARE:
STEEL, HOT DIP GALVANIZED PER
ASTM-A153

COTTER PIN:
STAINLESS STEEL
- ULTIMATE STRENGTH: 10,000 LBS.
- CLAMPING RANGE - 0.23" TO 0.75"



ANGLE SUSPENSION CLAMP
ALS-1-N

This information is confidential and is the property of Maclean Power Systems. It may not be made public or reproduced except that the Customer may make copies for use solely in installation, maintenance, and operation of products supplied by Maclean Power Systems.

DATE: 12/29/2011	SCALE: NONE	NO.	BC8594-1	R / 0	SH. 1 / OF 1
DWN. BY: CDR	CKD. BY:	APR. BY:			

ENG. REF.