

REVISIONS				
NO.	DATE	DESCRIPTION	BY	CHKD
1	10/18/12	ADDED GCC15-26	LV	KK
2	03/05/18	ADDED GCC15-230&240	MBG	

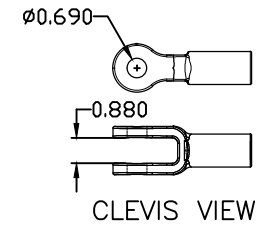

CATALOG NUMBER	LENGTHS (IN)		ULTIMATE STRENGTHS		ELECTRICAL WITHSTAND	
	L1	L2	TENSILE, LBS (F1)	DRY, kV	WET, kV	
GCC15-12	12	20.000	15,000	90	45	
GCC15-18	18	26.000	15,000	126	67.5	
GCC15-24	24	32.000	15,000	180	90	
GCC15-26	26	34.000	15,000	195	97.5	
GCC15-30	30	38.000	15,000	225	112.5	
GCC15-36	36	44.000	15,000	270	135	
GCC15-42	42	50.000	15,000	315	157.5	
GCC15-45	45	53.000	15,000	337.5	168.75	
GCC15-48	48	56.000	15,000	360	180	
GCC15-54	54	62.000	15,000	405	202.5	
GCC15-60	60	68.000	15,000	450	225	
GCC15-78	78	86.000	15,000	585	292.5	
GCC15-96	96	104.000	15,000	720	360	
GCC15-108	108	116.000	15,000	810	405	
GCC15-120	120	128.000	15,000	900	450	
GCC15-144	144	152.000	15,000	1080	540	
GCC15-230	230	238.000	15,000	1725	862.5	
GCC15-240	240	248.000	15,000	1800	900	

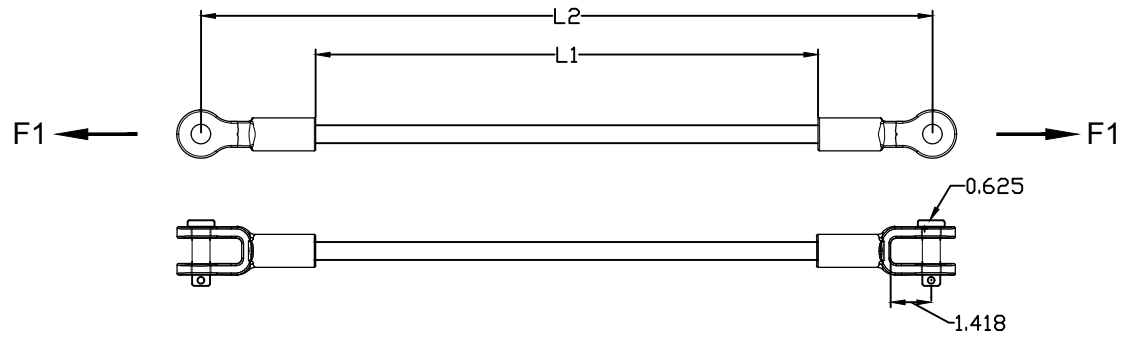
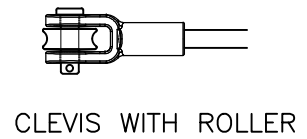
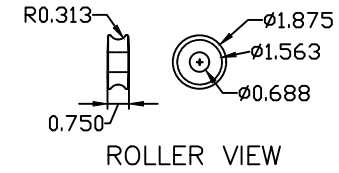

- NOTES:
- MATERIAL
 - END FITTING - DUCTILE IRON 654512
 - ROD - FIBERGLASS
 - CLEVIS PIN - C1018 STEEL (SAE GRADE 2)
 - COTTER KEY - STAINLESS STEEL
 - FINISH
 - END FITTING - HOT DIP GALVANIZED PER ASTM-A-153
 - ROD - ULTRAVIOLET PROTECTIVE VEIL COATING, GRAY
- SILICONE COATED RUBBER FIBERGLASS ROD, GRAY FOR "SC" OPTION
 - CLEVIS PIN - HOT DIP GALVANIZED PER ASTM-A-153
 - COTTER KEY - NONE
 - DIMENSIONS IN INCHES

NOTE: ADDED SUFFIX "R" FOR ONE ROLLER AND "R2" FOR TWO ROLLERS.
 EX. GCC15-24R FOR ONE OR GCC15-24R2 FOR TWO ROLLERS.
 ADDED SUFFIX "SC" INDICATES SILICONE COATED RUBBER FIBERGLASS ROD.
 EX. GCC15-24RSC FOR ONE ROLLER AND SILICONE COATED ROD.

MACLEAN POWER SYSTEMS
 A Maclean-togg Company

GCC15-"L1", R, R2 SERIES

15K GUY STRAIN INSULATOR
 CLEVIS - CLEVIS END FITTING

DATE: 03-22-12 SCALE: 1:1 NO. CEB-3826

BY: LV CHKD: MBG

This information is confidential and is the property of Maclean Power Systems. It may not be made public or reproduced except that the Customer may make copies for use solely in installation, maintenance and operation of products supplied by Maclean Power Systems.

ENG. REF.