

A

B

| | | |
|------------|----------------|-------|
| PAPER SIZE | DRAWING NUMBER | |
| A SIZE | GD-7196 | |
| REV | REVISION DATE | ECO |
| A | 05-12-11 | 10239 |
| B | 10-31-16 | 12335 |

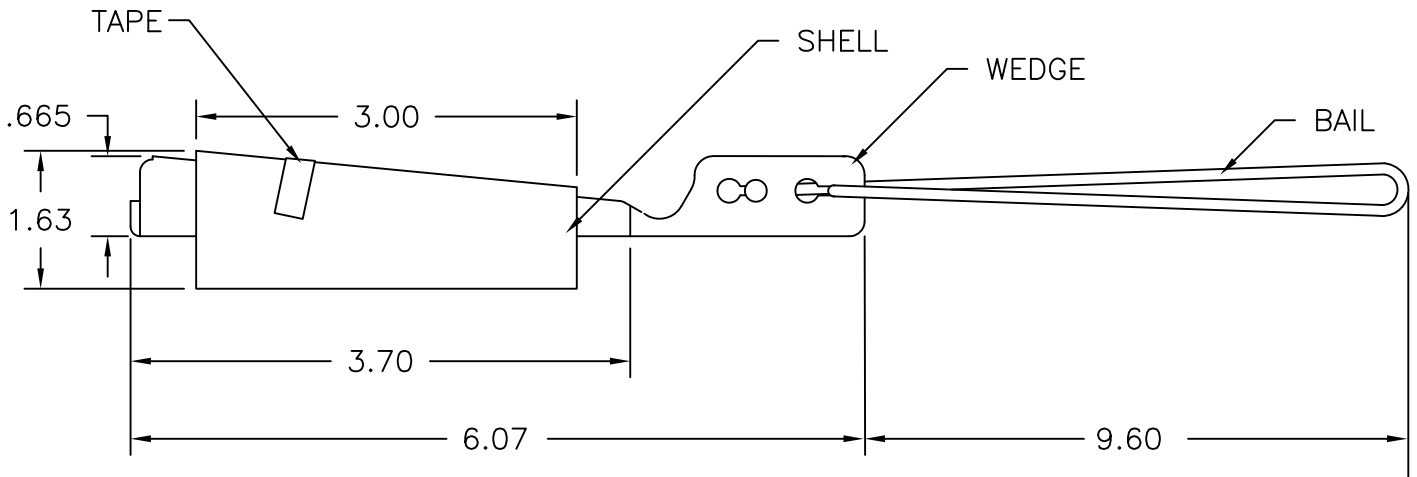

CATALOG NO. 7196

M.B.S.: 1,000 LBS.

MATERIAL:

BAIL - STAINLESS STEEL

SHELL - ALUMINUM ALLOY

WEDGE - ALUMINUM ALLOY

TAPE - COLOR (ORANGE)

ⓑ REFER TO 1914-066 FOR INSTALLATION INSTRUCTION.

USE OR REPRODUCTION OF THIS DRAWING FOR THE PURPOSE OF MANUFACTURING THIS ARTICLE OR ARTICLES SHOWN OR ANY OTHER PURPOSE IS STRICTLY PROHIBITED EXCEPT ON WRITTEN PERMISSION.

MACLEAN POWER SYSTEMS

DRAWING-COMPUTER LOCATION

| | |
|-----------------------------|---------|
| TOLERANCES UNLESS SPECIFIED | |
| INCH[mm] | |
| 0.XX | ± [±] |
| 0.XXX | ± [±] |
| ANGLE | ± |



**MACLEAN
POWER
SYSTEMS**

RELIABLE POWER PRODUCTS
11411 ADDISON STREET
FRANKLIN PARK, IL. 60131

| | | | | | |
|-----------------------------|----------|---------|-----------|-------|----------------|
| DRAWN BY | ENGINEER | CHECKER | CATALOG # | SCALE | DESIGN DATE |
| PDR | MRM | JBB | 7196 | --- | 05-12-11 |
| DRAWING TITLE / DESCRIPTION | | | | | DRAWING NUMBER |
| WEDGE CLAMP - ALUMINUM | | | | | GD-7196 |