

A | B | C | D | E | F

PAPER SIZE	DRAWING NUMBER	
B SIZE	GD-J26965	
REV	REVISION DATE	ECO
A	08-24-17	D8744

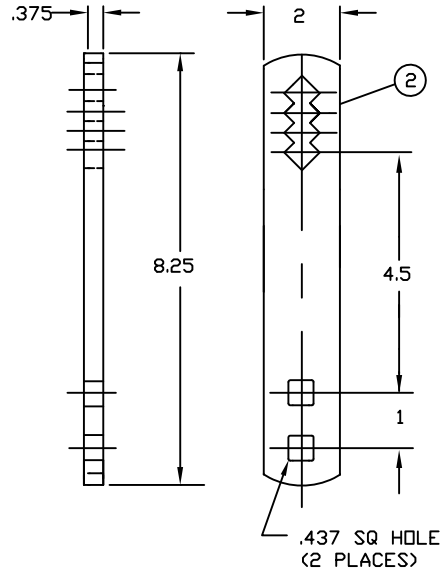
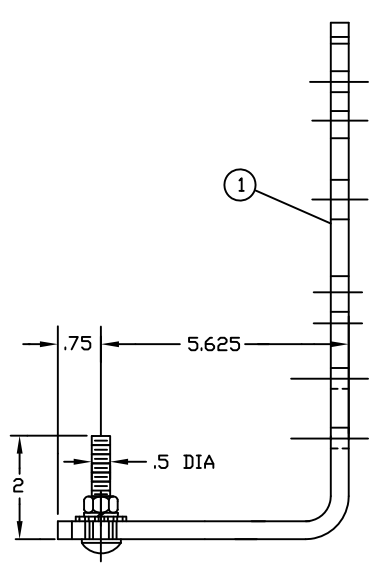
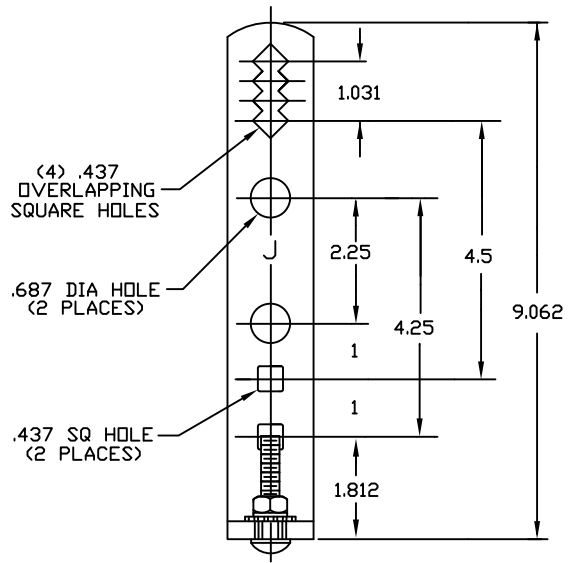

ITEM	QTY	DESCRIPTION
1	1	.375 X 2.000 ANGLE STRAP ASSY
2	1	.375 X 2.000 BACK STRAP

NOTES:
 1) ALL DIMENSIONS ARE REFERENCE AND ARE IN INCHES
 2) ALL ITEMS HOT DIP GALVANIZED

PER DUKE POWER SPEC. CODE 39409 PART NO. F-102396

This drawing contains confidential information that is the property of MacLean Power, L.L.C. ("MacLean"). Use of MacLean's confidential information without MacLean's express written consent is strictly prohibited and may expose you to legal liability. If you believe that you received this material in error, please destroy it or return it to "MacLean Power, L.L.C., 11411 Addison, Franklin Park, Illinois 60131, USA."

DRAWING-COMPUTER LOCATION:
 DRAWING-COMPUTER LOCATION:

TOLERANCES UNLESS SPECIFIED	inch
0.XX	----
0.XXX	----
ANGLE	----



DRAWN BY	ENGINEER	CHECKER	CATALOG #	SCALE	DESIGN DATE
RPM	RPM	FJS	J26965	NTS	4-19-04
DRAWING TITLE / DESCRIPTION					DRAWING NUMBER
CROSSARM MOUNTING BRACKET ASSEMBLY					GD-J26965

Form: 00_Bkstr / 03-22-05