

CATALOG NUMBER:
SI-4040

ITEM NO.	DESCRIPTION	MATERIAL	FINISH	QTY.
1	POLE STEP CASTING	A356 ALUMINUM ALLOY	BARE	1
2	5/8-11 J-BOLT - TDG	HR CARBON STEEL, 75 KSI MIN.	TDG	1
3	5/8-11 SQUARE NUT - TDG	CARBON STEEL	TDG	1
4	5/8-11 LOCK NUT - TDG	CARBON STEEL	TDG	1

SHEET SIZE		DRAWING NUMBER		
B		GD-SI4040		
REVISIONS				
ZONE	REV.	REVISED BY:	REV. DATE:	ECO #
	A1	JRK	12/8/2025	TBD

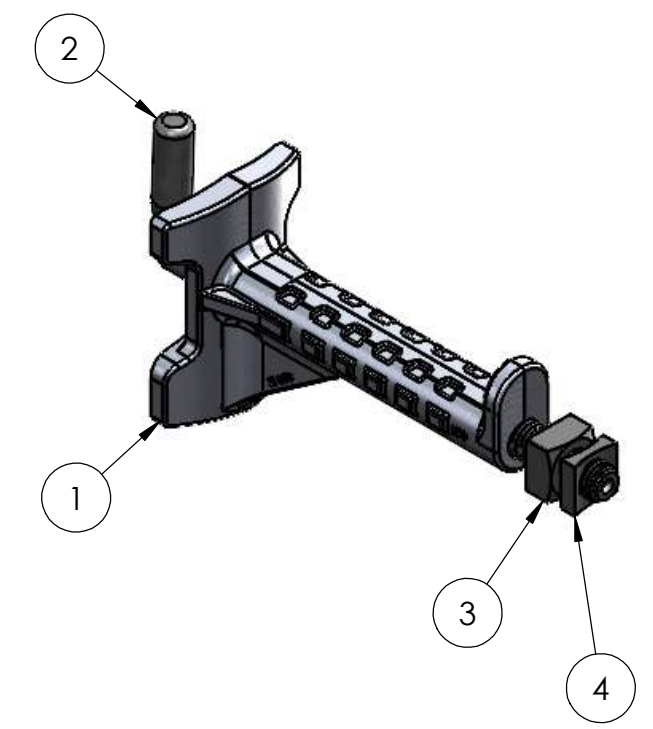
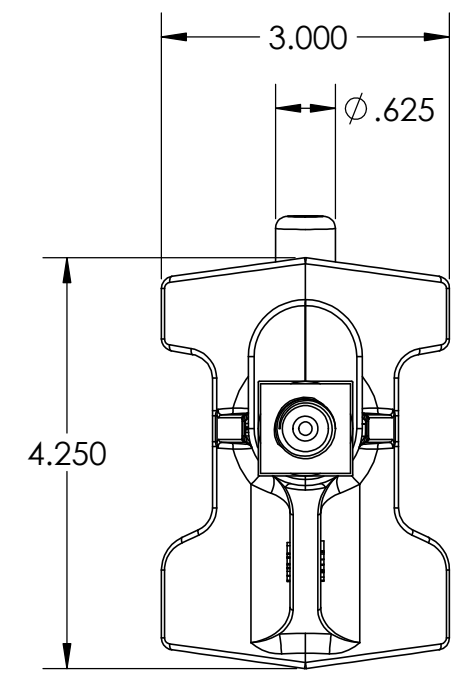
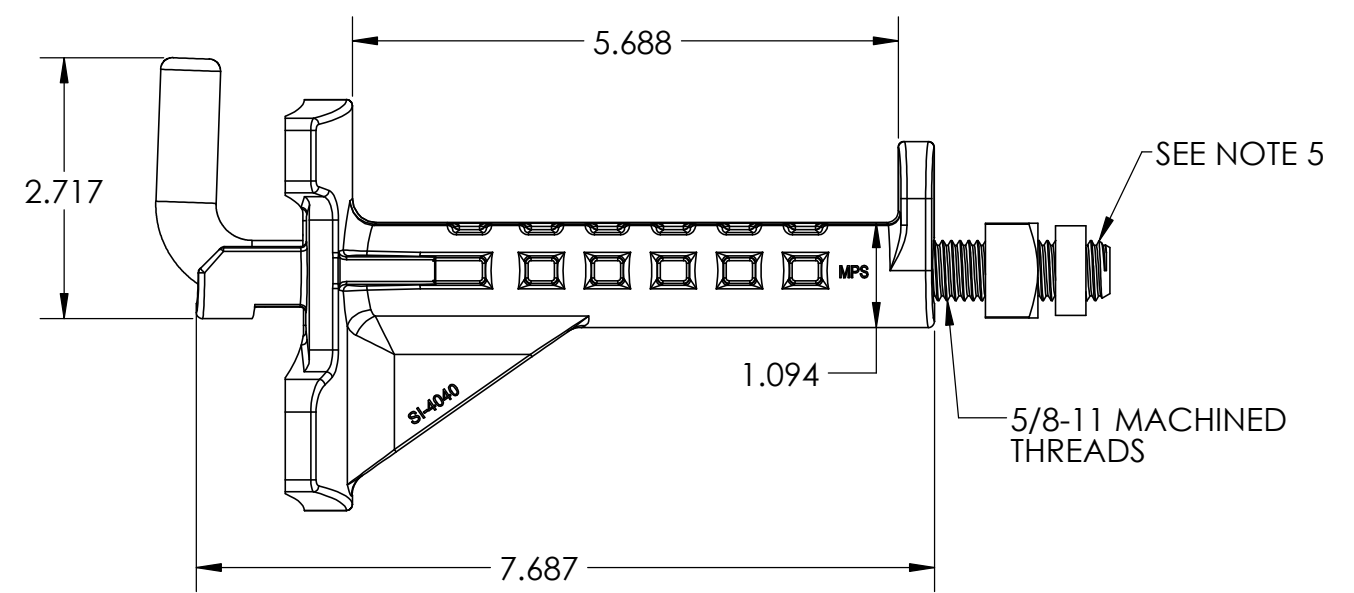
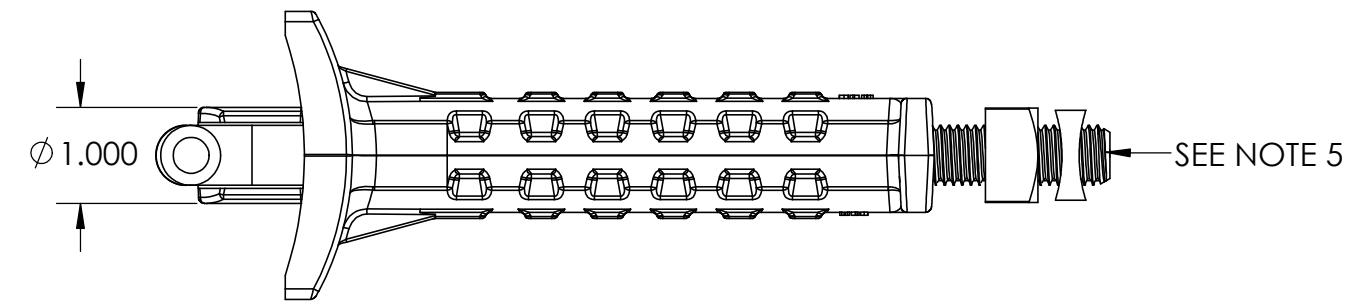

NOTES:

1. ALL DIMENSIONS ARE REFERENCE AND IN INCHES.
2. POLE DIAMETER RANGE: 12" - 20"
3. POLE WALL THICKNESS RANGE: 0.350" - 1.575"
4. HOLE DIAMETER REQUIRED FOR INSTALLATION: 1.125"
5. PAINT MARK ON J-BOLT TO INDICATE ORIENTATION OF BEND.

This drawing contains confidential information that is the property of MacLean Power Systems™ ("MPS"). Use of MPS's confidential information without MPS's express written consent is strictly prohibited and may expose you to legal liability. If you believe that you received this material in error, please destroy it or return it to "MacLean Power Systems, 1465 Industrial Park Dr., Trenton, TN 38382, USA."

UNLESS OTHERWISE SPECIFIED DIMENSIONS ARE IN:	
INCHES	
TOLERANCES ARE:	
.XX	-----
.XXX	-----
X/XX	-----
ANGLES	-----

PART NUMBER: **F105930**

MacLean
POWER SYSTEMS

WWW.MACLEANPOWER.COM

DRAWING NUMBER: **GD-SI4040**

SHEET NUMBER: **1 OF 1** MAKE OR PURCHASE: **M**

PART DESCRIPTION: **CAST POLE STEP ASSEMBLY**

DRAWING SCALE: **1:2**

DO NOT SCALE DRAWING

DRAWING TO BE INTERPERATED IN ACCORDANCE WITH ASME Y14.5

DESIGN DATE: **9/16/2025**

DRAWN BY: **JRK**

APPROVED:

DEPT: **DH** WEIGHT (LBS): **2.07**

REVISION: **A1**