



MacLean Power Systems
 7801 Park Place Rd., York, SC 29745
 USA (803) 628-2100

MPS Catalog Number

H0 40 70 006 MX SS 003

Revision: A

Date 11/4/2020

End Fittings

Tower End Fitting: 3/4"-10 Round Base (Galv. Duct. Iron)

Line End Fitting: F-Neck (Aluminum)

Material

Number of Sheds: 3
 Rod Diameter: 1-1/2"
 Weight Estimate: 7.6 lbs 3.4 kg

Dimensional Values

Section Length (L): 13.7 in 348 mm
 Rubber Length (X): 5.9 in 150 mm
 Shed Height (P): 2.3 in 58 mm
 Shed Diameter (B): 6.5 in 165 mm
 Shed Spacing (S): 2.0 in 51 mm
 Dry Arc Distance: 8.2 in 208 mm
 Leakage Distance: 18.3 in 465 mm

Electricals Values

60 Hz dry Flashover: 112 kV Min. Withstand 91 kV
 60 Hz Wet Flashover: 84 kV Min. Withstand 55 kV
 Positive CIFO: 170 kV Min. Withstand 138 kV
 Negative CIFO: 209 kV Min. Withstand 169 kV

Mechanical Values

Max. Design Cant. Load (MDCL): 1,350 lbs 6.01 kN
 Specified Cant. Load (SCL): 2,800 lbs 12.5 kN
 Specified Tensile Load (STL): 5,000 lbs 22.2 kN

This drawing contains confidential information that is the property of MacLean Power, L.L.C. ("MacLean"). Use of MacLean's confidential information without MacLean's express written consent is strictly prohibited and may expose you to legal liability. If you believe that you received this material in error, please destroy it or return it to "MacLean Power, L.L.C., 7801 Park Place Rd., York, South Carolina 29745, USA."

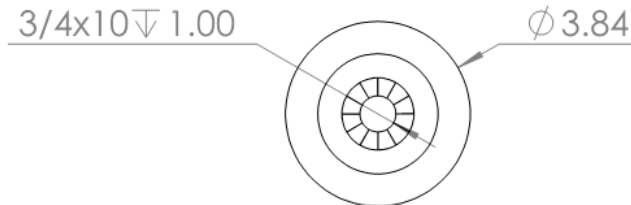
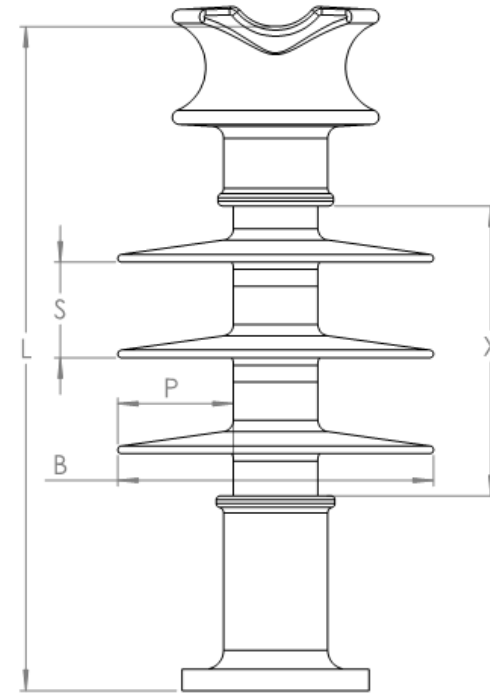

Dimension: inches [millimeters]

Insulator assembly complies with ANSI C.29.18 and CSA C411.6 Standards

NOTE: Drawing not actual depiction of insulator appearance