

7652AP and 7652APCRS Comparison

Below is a quick guide to the differences between MacLean Power's standard 7652AP splice and the 7652APCRS (Corrosion Resistant Splice). Both splices are rated to hold 95% rated breaking strength of the conductor used.

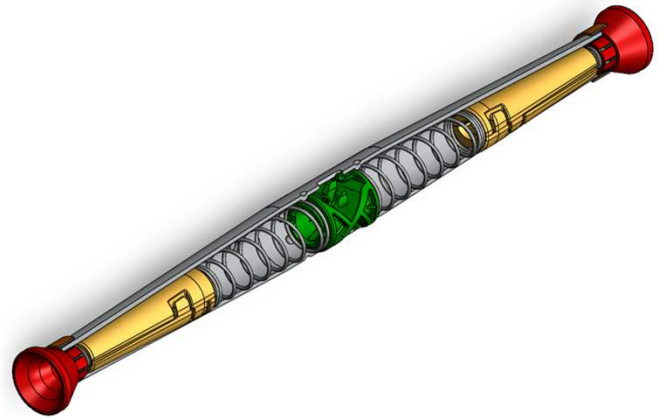
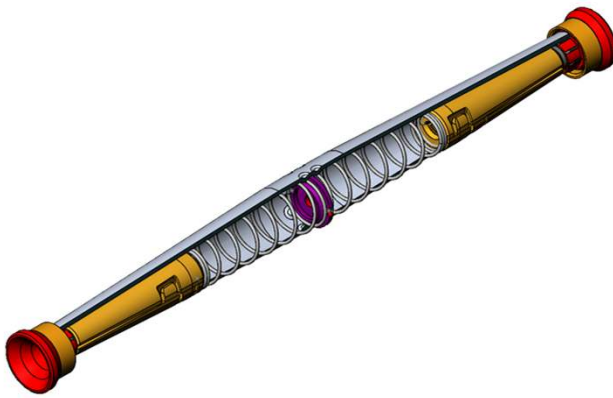

7652AP

7652APCRS

Splice Type	Range taking automatic	Range taking automatic; Corrosion resistant and insertion indicator
Color Code	Red/Orange	Red/Orange
Approved Conductors	#2 & #4 ACSR, AAAC, & AAC	#2 & #4 ACSR, AAAC, & AAC
Applicable Standard	ANSI C119.4 Full tension, class A	ANSI C119.4 Full tension, class A
Jaws	Die Cast Aluminum	Die Cast Aluminum
Tube	Aluminum Alloy	Aluminum Alloy
Overall Length	11.6 inches	12.1 inches
Spring	Galvanized Steel Wire	Stainless Steel Wire
Center Barrier	Center Disc	Pop Up Tab to verify proper insertion
Corrosion Protection	Standard inhibitor	Synthetic grease
Standard Pack Quantity	100	100

Both versions of the automatic splice are field-proven with millions of each having been shipped to several utilities. Contact your local sales rep for ordering information.