

A | B | C | D | E | F

|            |                |       |
|------------|----------------|-------|
| PAPER SIZE | DRAWING NUMBER |       |
| B SIZE     | GD-J740Z       |       |
| REV        | REVISION DATE  | ECO   |
| A          | 06-11-19       | D9557 |

1

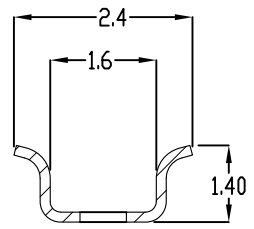
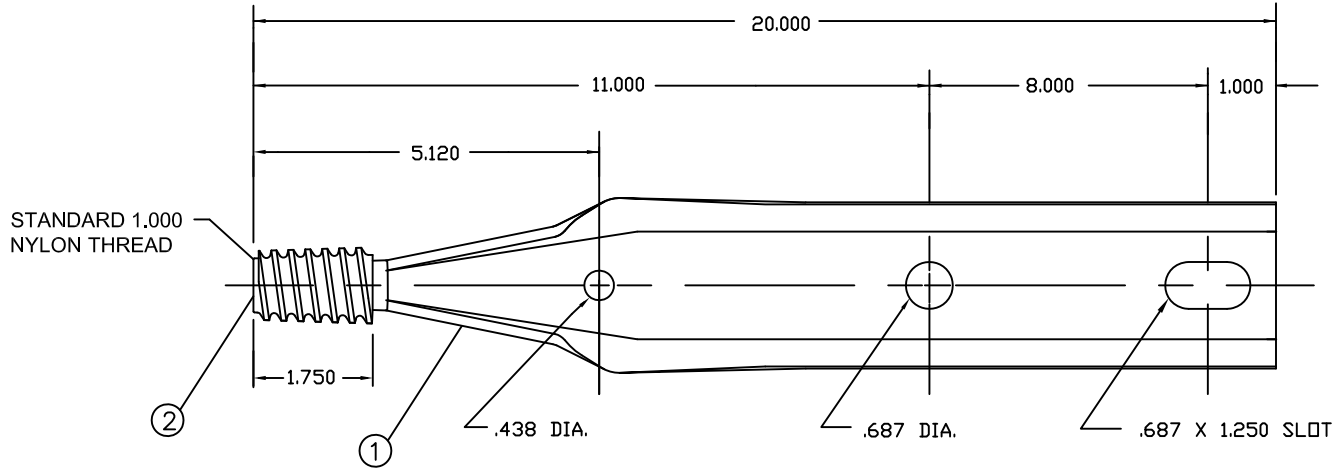

END VIEW

2

| ITEM | DESCRIPTION                 |
|------|-----------------------------|
| 1    | POLE TOP PIN STEEL BODY     |
| 2    | STANDARD 1.000 NYLON THREAD |

NOTES:

- 1. PIN STEEL GALVANIZED PER ASTM A-153.
- 2. ALL DIMENSIONS ARE REFERENCE AND IN INCHES.

|           |       |
|-----------|-------|
| CATALOG # | J740Z |
|-----------|-------|

3

4

This drawing contains confidential information that is the property of MacLean Power, L.L.C. ("MacLean"). Use of MacLean's confidential information without MacLean's express written consent is strictly prohibited and may expose you to legal liability. If you believe that you received this material in error, please destroy it or return it to "MacLean Power, L.L.C., 11411 Addison, Franklin Park, Illinois 60131, USA."

|                             |      |
|-----------------------------|------|
| TOLERANCES UNLESS SPECIFIED |      |
| inch                        |      |
| 0.XX                        | ---- |
| 0.XXX                       | ---- |
| ANGLE                       | ---- |



|                             |          |         |           |       |                |
|-----------------------------|----------|---------|-----------|-------|----------------|
| DRAWN BY                    | ENGINEER | CHECKER | CATALOG # | SCALE | DESIGN DATE    |
| MTT                         | DEK      | MTT     | J740Z     | NTS   | 08/08/08       |
| DRAWING TITLE / DESCRIPTION |          |         |           |       | DRAWING NUMBER |
| POLE TOP PIN                |          |         |           |       | GD-J740Z       |