

8 7 6 5 4 3 2 1

PAPER SIZE		DRAWING NUMBER	
<b>B</b>		<b>GD-J9414</b>	
REV	REVISED BY	REVISION DATE	ECO #
A	RC	07/30/09	9597
B	PDR	08/07/12	10683

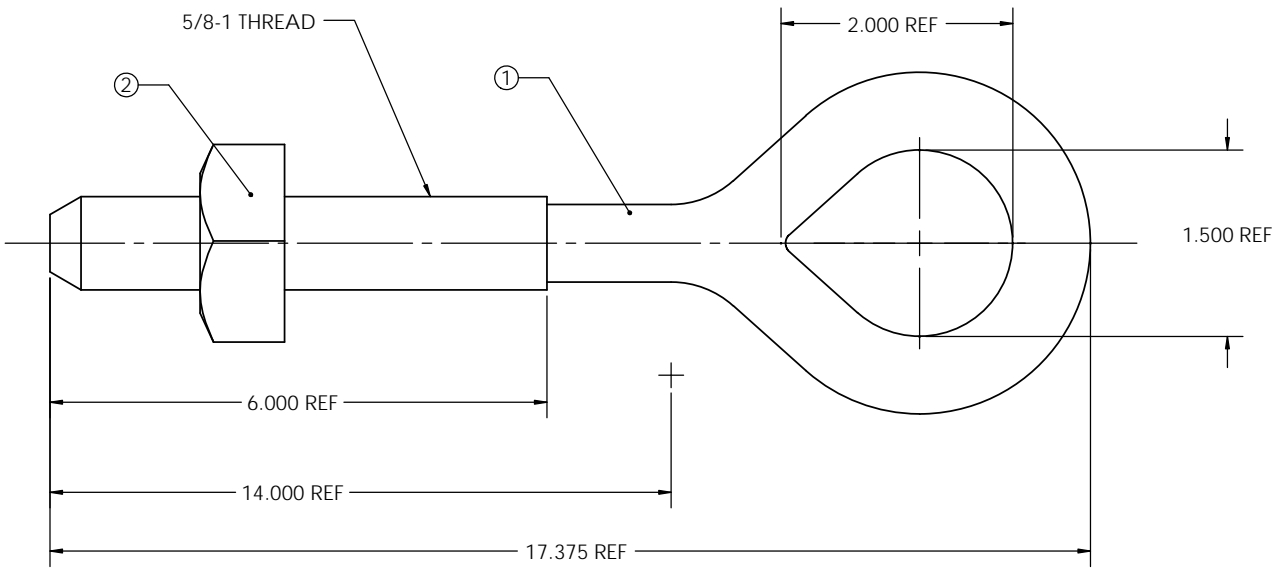

**NOTES:**  
 1. MATERIAL: HOT ROLLED CARBON STEEL  
 2. ALL DIMENSIONS ARE REFERENCE AND ARE IN INCHES.  
 3. ALL ITEMS ARE HOT DIP GALVANIZED PER ASTM A153.  
 4. MINIMUM TENSILE STRENGTH: 13,550 LBS.

ITEM	QTY	DESCRIPTION
1	1	BOLT OVAL EYE 5/8
2	1	NUT SQUARE 5/8

This drawing contains confidential information that is the property of MacLean Power, L.L.C. ("MacLean"). Use of MacLean's confidential information without MacLean's express written consent is strictly prohibited and may expose you to legal liability. If you believe that you received this material in error, please destroy it or return it to "MacLean Power, L.L.C., 11411 Addison Street, Franklin Park, Illinois 60131, "USA."

UNLESS OTHERWISE SPECIFIED DIMENSIONS ARE IN:	
<b>INCHES</b>	
TOLERANCES ARE:	
XX	+/- .XX
.XXX	+/- .XXX
X/XX	+/- X/XX
ANGLES	+/- .XXX

CATALOG NO: J9414

**MACLEAN POWER SYSTEMS**  
 11411 ADDISON STREET  
 FRANKLIN PARK, IL 60131  
 TEL: (847) 455-0014 FAX: (847) 455-0029

PART NO: F614977	
DRAWING NUMBER: <b>GD-J9414</b>	
SHEET NAME: <b>Sheet1</b>	1 OF 1
DRAWING DESCRIPTION: BOLT OVAL EYE 5/8 X 14	
DRAWING SCALE: NTS	
DO NOT SCALE DRAWING	
CAD GENERATED DRAWING DO NOT MANUALLY UPDATE	
DESIGN DATE: 07/30/09	
DRAWN BY:	RC
ENGINEER:	DEK
APPROVED:	FJS

8 7 6 5 4 3 2 1